

▶ THERMAL CIRCUIT BREAKER FOR CURRENTS UP TO 100 A

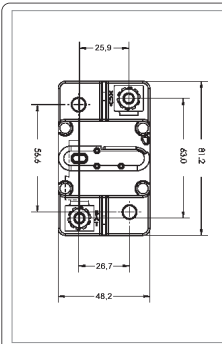

- TCB 30 A Order-No.: 7 0010 7181
- TCB 40 A Order-No.: 7 0010 7182
- TCB 50 A Order-No.: 7 0010 7183
- TCB 70 A Order-No.: 7 0010 7185
- TCB 100 A Order-No.: 7 0010 7187

High current thermal circuit breaker 25- 100A. Manual operation for build-on installation DC 48V. Terminal stud size M6. Protection IP67
Not suitable for protection of starter engines!

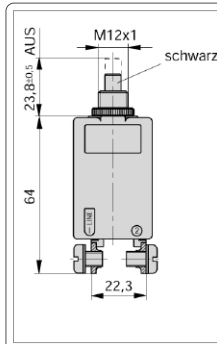

- 4130-G211-K4M1-30 A Order-No.: 1 4130 0030
- 4130-G211-K4M1-40 A Order-No.: 1 4130 0040
- 4130-G211-K4M1-50 A Order-No.: 1 4130 0050
- 4130-G211-K4M1-60 A Order-No.: 1 4130 0060
- 4130-G211-K4M1-70 A Order-No.: 1 4130 0070

Single pole thermal circuit breaker with an unstoppable release. Fitting hole \varnothing 12 mm. Width of breaker: 18 mm
Rated voltage DC 28 V. Current ratings 30...70A.
Splash water proof cap is available (see below)



- B017 Order-No.: 1 2107 3901
Protection cap for E-T-A 2-5700 for watertight panel installation, IP 64.
- B006 Order-No.: 1 2008 0101
Protection cap for E-T-A-413, 4130 for watertight panel installation, IP 66.



- MPE 120 Order-No.: 0 2800 4500
Mounting panel for 2 circuit breakers series 2-5700, 413, 4130.
Circuit breakers have to be ordered separately!

▶ BOLT FUSES AND TERMINAL FUSE BLOCKS UP TO 300 A

The terminal fuse block ABH 1 is designed for an easy and space saving installation of high current bolt fuses directly on a battery or a bus bar.

Maximum current of the fuse holder ABH 1 is 300A. Rated voltage 58V.

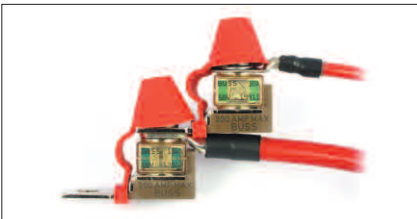
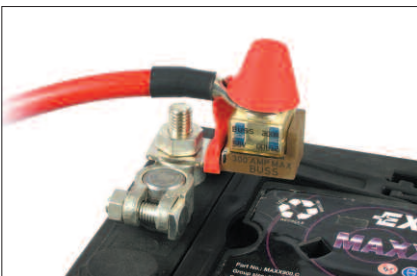

Optional cascade installation for fusing of different wire diameters at one place.



- ABH 1 Order-No.: 7 0010 5191
Terminal fuse block for a single bolt fuse SHB. For protection of different wire-diameters at one bolt. Delivery without bolt fuse SHB, please order separately!
- Dimensions** L 63 x B 21 x H 47 mm
- Bolt** M 8
- Mounting hole** 10 mm

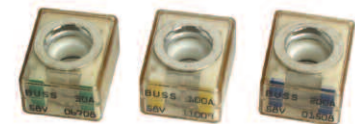

- SHB 30 A Order-No.: 6 0892 5301
- SHB 50 A Order-No.: 6 0892 5501
- SHB 75 A Order-No.: 6 0892 5751
- SHB 100 A Order-No.: 6 0892 6101
- SHB 125 A Order-No.: 6 0892 6121
- SHB 150 A Order-No.: 6 0892 6151
- SHB 200 A Order-No.: 6 0892 6201
- SHB 250 A Order-No.: 6 0892 6251
- SHB 300 A Order-No.: 6 0892 6301

Fuses for M 8 - bolt. Rated voltage DC 58V